

HOSPITAL CONSTRUCTION.

THE WARNEFORD HOSPITAL, LEAMINGTON.

This very excellent institution appears to have grown out of a charity established for the purpose of giving free baths of the well-known Spa waters to poor patients. "The Leamington Spa Charity," as it was called, was founded by Benjamin Satchwell, the poet, in 1806, and was in 1826 merged with a dispensary and infirmary then carried on in Regent Street. As the population of Leamington grew with the increasing fame of its saline waters, the house in Regent Street became inadequate for the growing work of the charity, and in 1831 a public meeting was held in order to establish an infirmary on a wider and firmer basis. About this time the Rev. Dr. Warneford, rector of Bourton-on-the-Hill, was staying at Leamington, and interested himself in the scheme to such good purpose that within a short time he, on his own behalf and that of his sister, added to the funds of the hospital a total sum of £2,500. And not alone by gifts of money did Dr. Warneford show his interest in the work, but, being elected on the committee, he gave liberally of his time until age and infirmity precluded his further attendance. On his death it was found that he had bequeathed £10,000 upon trust for the benefit of the hospital under certain conditions.

The site in the Radford Road upon which the hospital

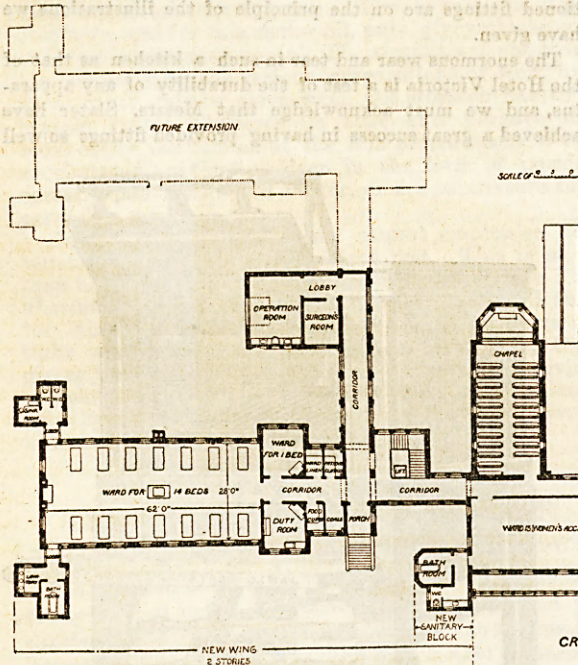

ing year the west wing was erected. The hospital now with these various additions possessed eighty-six beds in the main building and twenty in the sanatorium.

In 1877 the committee wisely decided to remove the outpatient department from within the walls of the hospital, and accordingly built the one storey detached wing in which this part of the work is at present carried on. In 1880 the women's ward, with the children's ward above, was built, and a new laundry and covered way to the nurses' home (late sanatorium) were built.

A new cottage hospital for the treatment of infectious

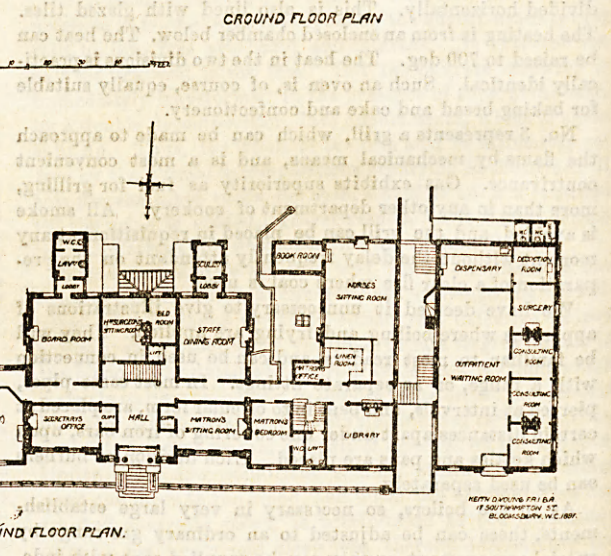
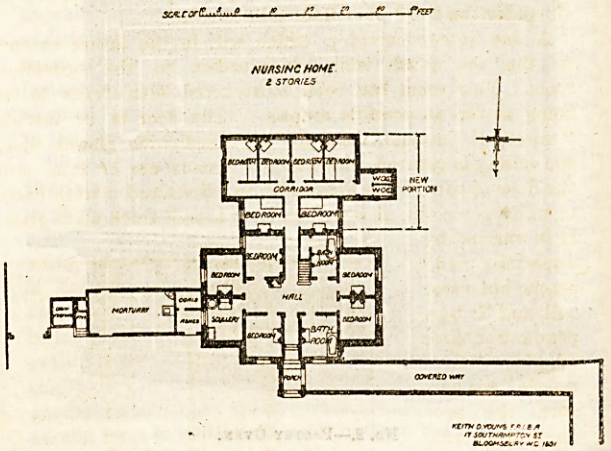

THE WARNEFORD HOSPITAL, LEAMINGTON.

stands was purchased in 1832, and the erection of the new buildings proceeded with. The new hospital which was opened in 1834 comprised what is now the central block of the old building, and contained six wards, with accommodation for twenty-four beds, four of which were in accordance with a stipulation made by Dr. Warneford, to be appropriated to patients from the Radcliffe Infirmary, Oxford, and four for bathing patients. In 1835 the Leamington Charity Bathing Institution was amalgamated with the hospital. It was not, however, until 1856 that funds were forthcoming for furnishing and opening the whole of the wards, and in this year the east wing, containing the outpatients' department and laundry, were built.

In 1862 the building which is now the home for nurses was erected as a sanatorium. In 1867, through the help of the Warneford Trustees, the chapel was built, and in the follow-

fevers was built in 1884 by the Rev. J. A. Beaumont, as a memorial to his son, after whom it is called the "Herbert Beaumont Cottage Hospital."

In 1890 the committee, having purchased additional land to the west of the hospital, determined to build additional wards and an operation-room, and at the same time to re-organize the internal arrangements of the old house and to enlarge the nurses' home.

The plans we publish show the ground floor of the hospital with the new wing and operation-room, and the outline of the proposed new wing to the south of the operation-room, and the ground plan of the nurses' home.

The new ward wing is two storeys in height, and contains on each floor a ward for fourteen beds, a separation ward for one bed, nurses' duty-room, store-rooms for linen, patients' clothes and food, and the usual sanitary offices.

The wards have wax-polished oak floors, and the walls are painted and varnished. Each ward is warmed by three Boyd's hygiastic grates, two of them being placed in the centre of the ward and having descending flues. The sanitary offices are lined throughout with glazed bricks. The sink-rooms are fitted with McHardy slop sinks,* and the w.c.'s with Hellyer's pedestal hygienic apparatus.

Underneath the ground floor of the ward block is a basement storey, the part of which that is under the main ward being open at the sides, the remainder being fitted up as store-rooms, &c. As the ground floor is raised some feet above the ground level, this arrangement, besides affording a sheltered ambulatory for patients, allows a free sweep of air under the ward floor from side to side.

A one storey corridor, which will in the future extend to the new south wing, gives access to the operation room. This room has been constructed with a view to its being as far as possible aseptic. The floor is of marble "mischiati" mosaic, the walls are lined with glazed tiles, the ceiling is painted, the window frames are of iron, and the door of oak. It is fitted with two sinks and a wash-basin of white porcelain, all of which have tops of thick plate glass.

It is warmed by a specially made copper hot water coil, and lit by a pendant of three Sugg's "Cromartie" gas burners, the products of combustion from which are conducted into the open air.

In the surgeons' room adjoining is a specially designed instrument case made throughout of wainscot.

The only structural alteration to the old house consisted of the erection of the new sanitary wing to the women's accident ward and the children's ward above.

In expending money upon alterations the committee laid great stress upon the necessity for improving the accommodation for their nursing staff. One great need was a suitable sitting room for nurses when off duty. This was made by appropriating part of the men's ward on the ground floor of the east wing. This room looks due south, and makes a very pleasant and suitable room for the purpose, and the old sanitary offices adjoining being cleared out the space forms an excellent book-room. The remainder of this ward has been converted into a much needed linen-room, with a small office for the Matron adjoining.

The nurses' home has been enlarged by the addition of twelve bed-rooms and two bath-rooms.

In addition to these alterations the whole of the hot-water services, both for warming and for baths, &c., has been re-organised, and two new powerful boilers laid down; and the drains to the old house, which were examined by Dr. Geo. Wilson in conjunction with the architect, were relaid.

The whole of the works were carried out from the designs of Mr. Keith D. Young.

* An illustration and description of this apparatus appeared in our issue of May 14th, 1892.

CONSTRUCTION NOTES.

A NEW pavilion, with two wards containing fifty-two beds, is to be added to the Royal Hospital for Incurables, Dublin.

THE directors of the Dundee Royal Infirmary propose to erect a new operating theatre and other offices. The cost of these alterations is estimated at £119 12s. 6d.

SEVERAL alterations and improvements have been recently made in the heating, cooking, and washing departments of the Convalescent Home in connexion with the Dundee Royal Infirmary. The expense of these alterations has been borne by Mrs. Gilroy.

It is proposed to erect a temporary hospital for infectious diseases at Woodhouse, Keighley, at an estimated cost of £650. The building is to be of corrugated iron, lined with boards, with an accommodation for twelve beds. Messrs. Judson and Moore are the architects.

At the annual meeting of the Guest Hospital, Dudley, on the motion of Mr. E. Smith, seconded by Dr. Massiter, a resolution was carried to the effect that steps be taken at once to provide a private ward and operating-room for the female sick of the building, and the meeting pledged itself

to raise £400, or the sum needed in addition to £400 already in hand.

THE committee of the Royal Albert Hospital, Devonport, have decided to build a new operating theatre, with easy access by means of a lift to the wards of the hospital. A contract has been taken for £1,209 15s. for the new building and alterations, and the hydraulic lift will cost another £400. While this work is being

done the committee propose taking advantage of the opportunity to improve still further the sanitary arrangements of the hospital.

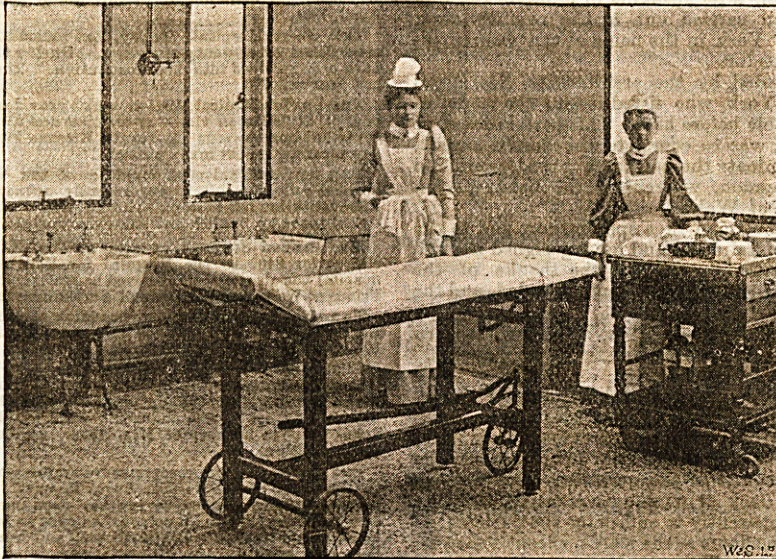

WARNFORD HOSPITAL.—THE OPERATION ROOM.

LITERARY INTELLIGENCE.

The third and fourth volumes, with portfolio of plans (completing the work), of Mr. Henry C. Burdett's "Hospitals and Asylums of the World," will be published by Messrs. J. and A. Churchill and the Scientific Press, about the end of this month. Vol. III. consists of hospitals, and deals with their history and administration in all countries throughout the world. Vol. IV. relates to hospital construction, and contains exhaustive bibliography and plans. The plans in the portfolio comprise those of the principal British, Colonial, American, and foreign hospitals, convalescent institutions, nurses' home, and medical school buildings, accurately drawn to the same scale, and replete with the fullest and most detailed information. It also contains plans of every hospital in London in the jubilee year of her Majesty's reign.